

# Bylaw # 1492 - Map 1/5

Area proposed for rezoning  
 from Grouped Country Residential (GCR) to  
 Rural Agriculture (RA)



Lots 2 & 3, Block 1, Plan 1412687  
 within NW 1/4 Sec 8, Twp 10, Rge 21, W4M  
 Lethbridge County



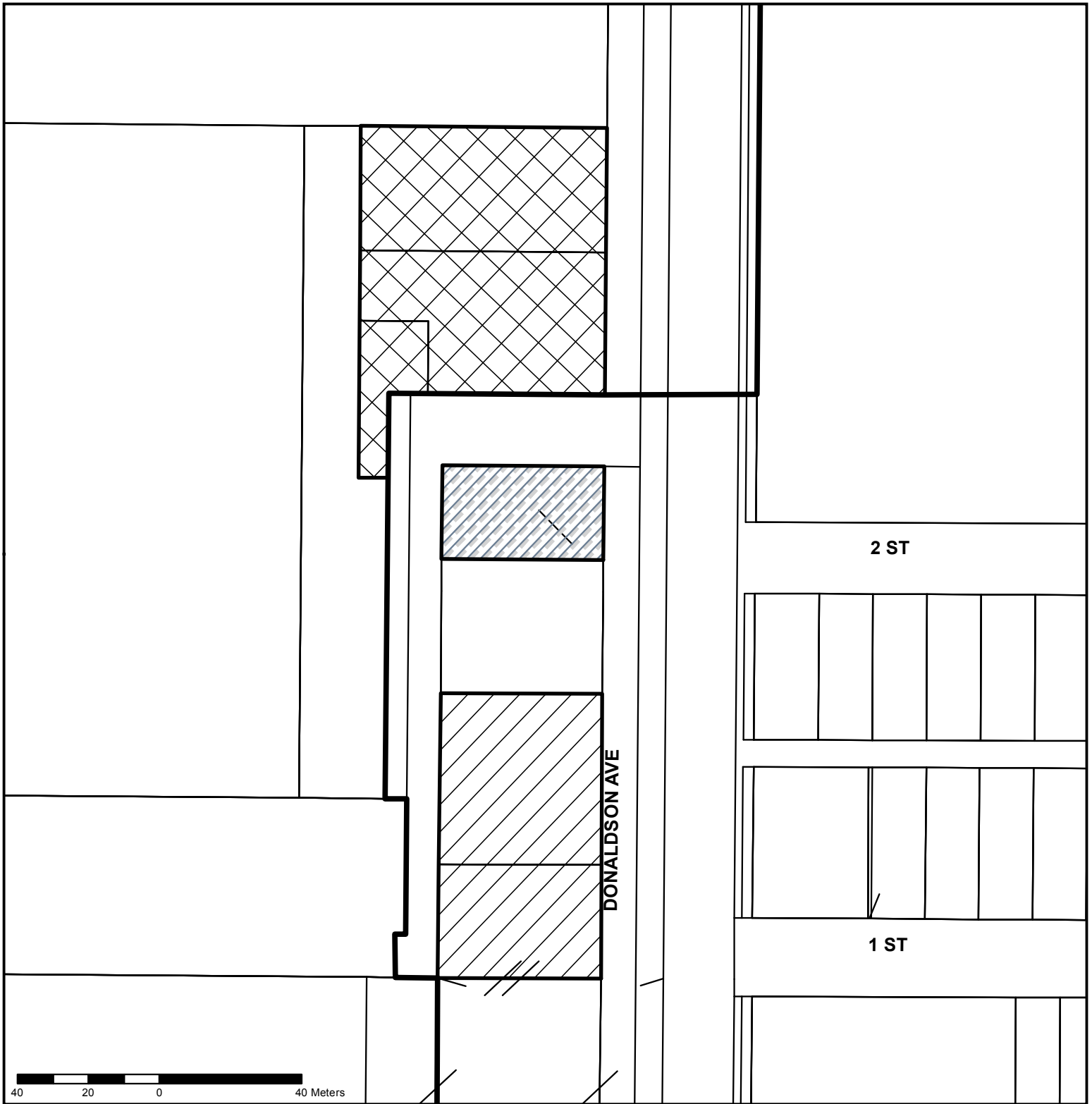

### Bylaw # 1492 - Map 5/5

Areas proposed for rezoning:



From Hamlet Commercial (HC) to Hamlet Industrial (HI)  
Parcel B, P Lan 8889FM & Portion of NE Sec 25



From Hamlet Public/Institutional (HP/I) to Hamlet Industrial (HI)  
Lot 1, Block 1, Plan 8910682



From Rural Urban Fringe (RUF) to Hamlet Industrial (HI)  
Lots 4, 5 & 7 PUL, Block 1, Plan 1611349

All Within NE 1/4 Sec 25 & NW 1/4 Sec 30, Twp 10, Rge 21, W4 Hamlet of Shaughnessy



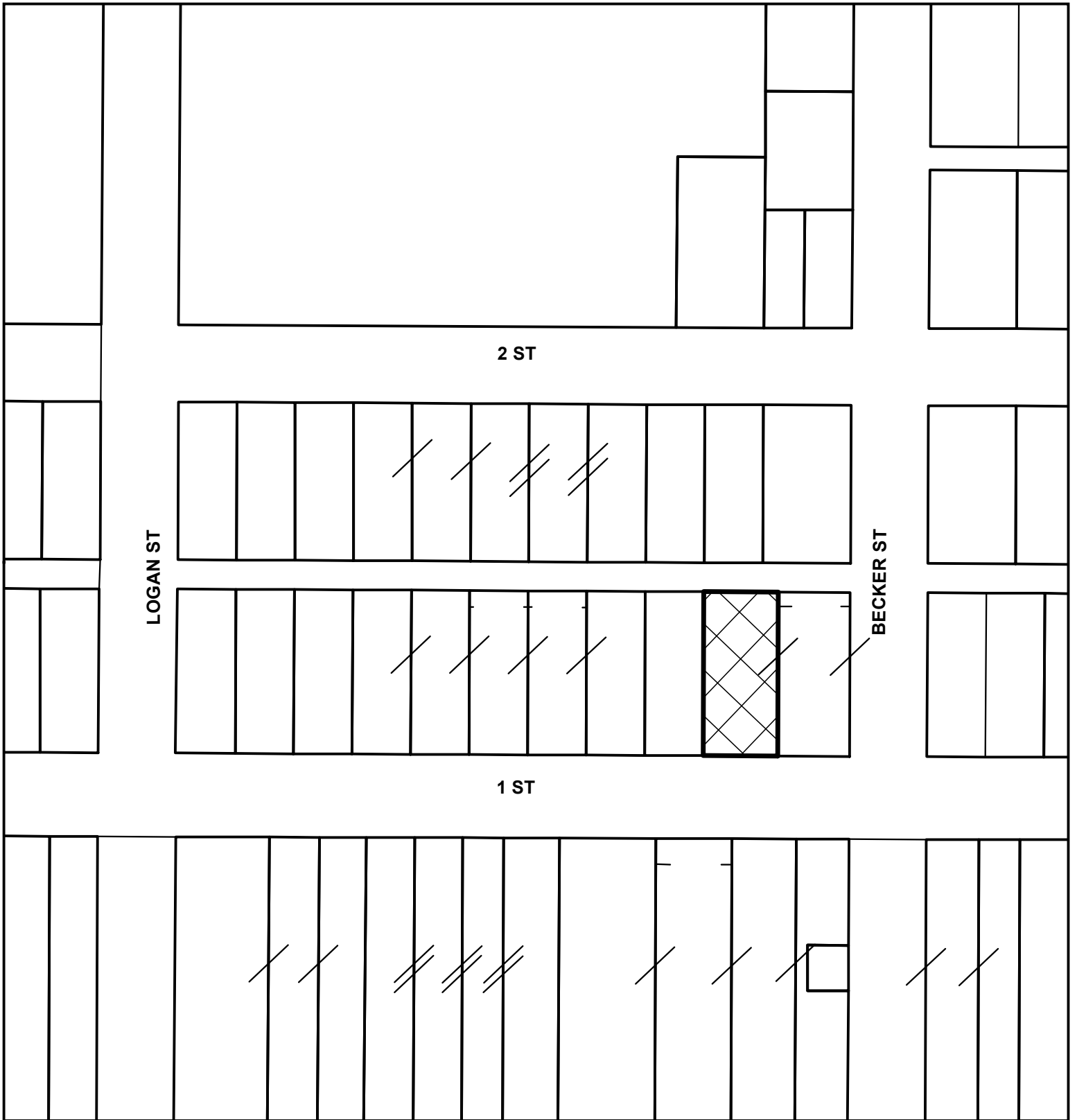

# Bylaw # 1492 - Map 4/5

Area proposed for rezoning  
 from Hamlet Commercial (HC) to  
 Hamlet Residential (HR)

Portion of Lot 1, Block 2, Plan 8183EA  
 Hamlet of Shaughnessy



Lethbridge County 2017  
 The information contained in this document is for informational and illustrative purposes only.  
 Lethbridge County will not be liable for any errors or omissions and is not responsible for reliance on the information. The equipment may not be used or installed in any form without  
 approval from Lethbridge County.



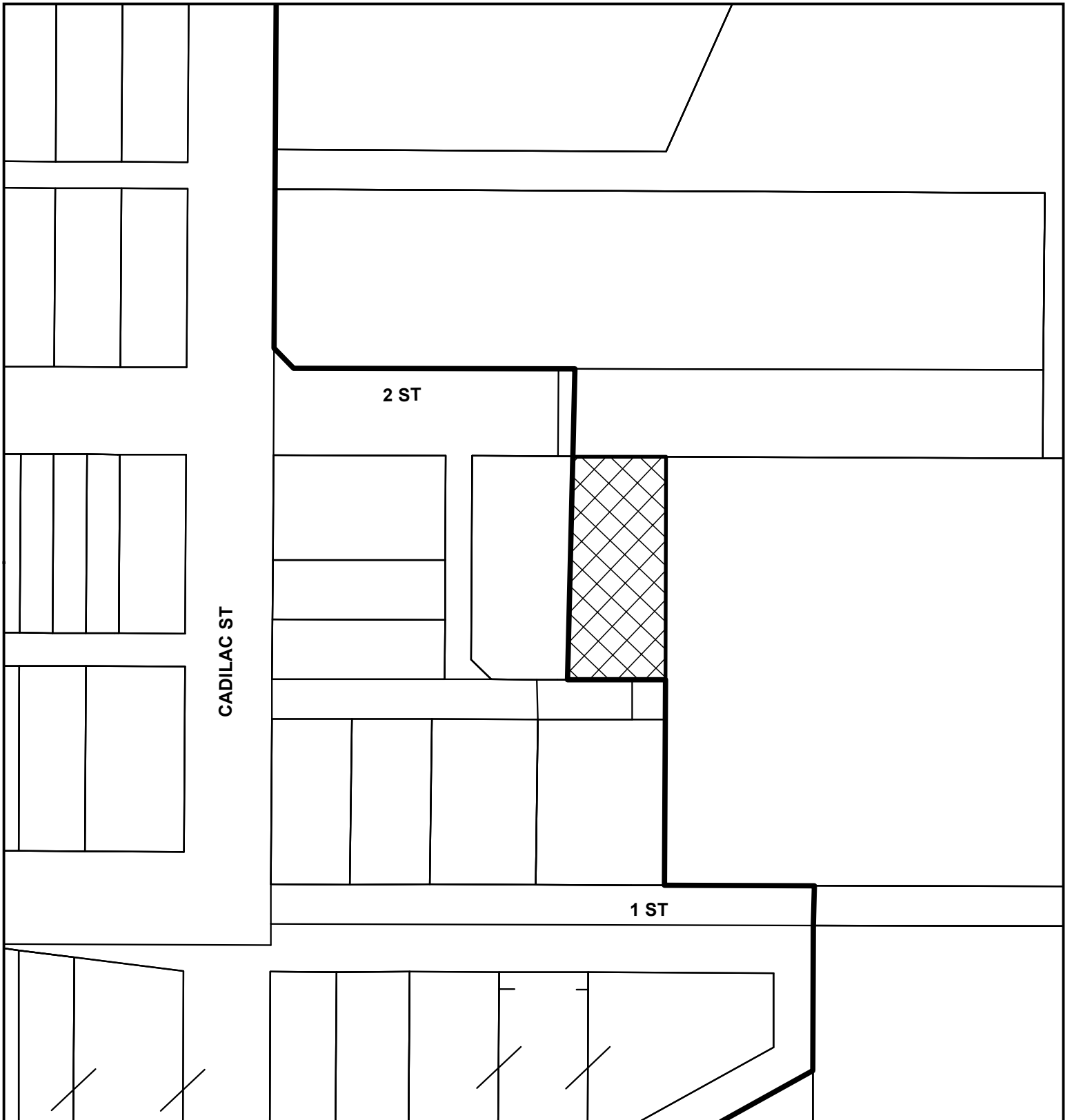

# Bylaw # 1492 - Map 3/5

Area proposed for rezoning  
 from Rural Urban Fringe (RUF) to Hamlet Industrial (HI)  
 Portion of Lot 10, Block 15, Plan 0110667

Hamlet of Shaughnessy

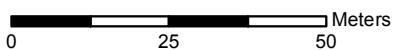

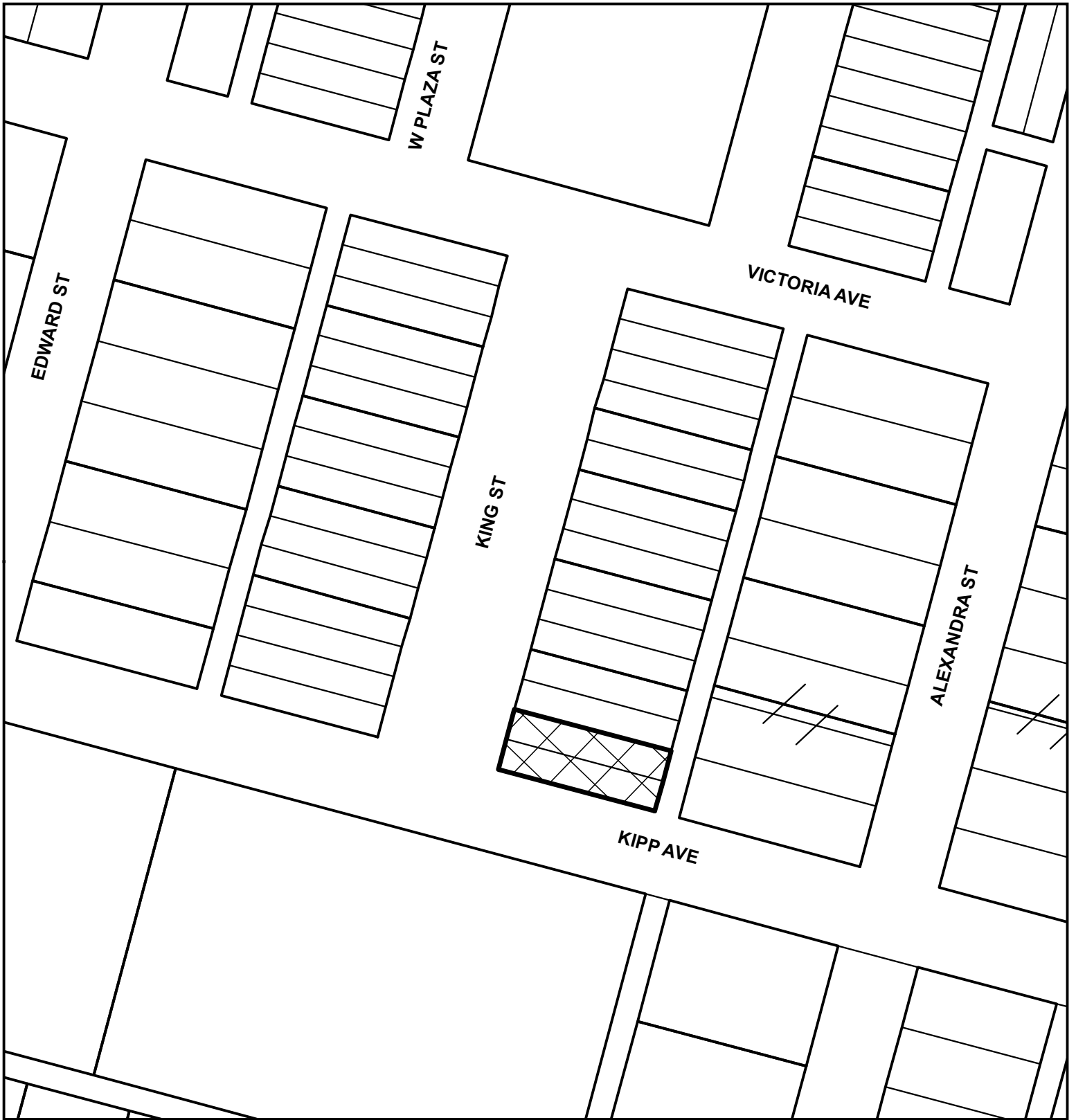

## Bylaw # 1492 - Map 2/5



Area proposed for rezoning  
 from Hamlet Commercial (HC) to  
 Hamlet Residential (HR)  
 Lots 9-10; Block 11; Plan 138A  
 Hamlet of Monarch

